

BÖLLHOFF

RIVQUICK® P1010-P2010

Hydro-pneumatic riveting tool for **RIVQUICK®** blind rivet

Instruction manual (Translation)

Technical Documentation

Art.-No.: 22603301000/00

Art.-No.: 22603401000/00

Ind. A – Doc No 22649900002/00

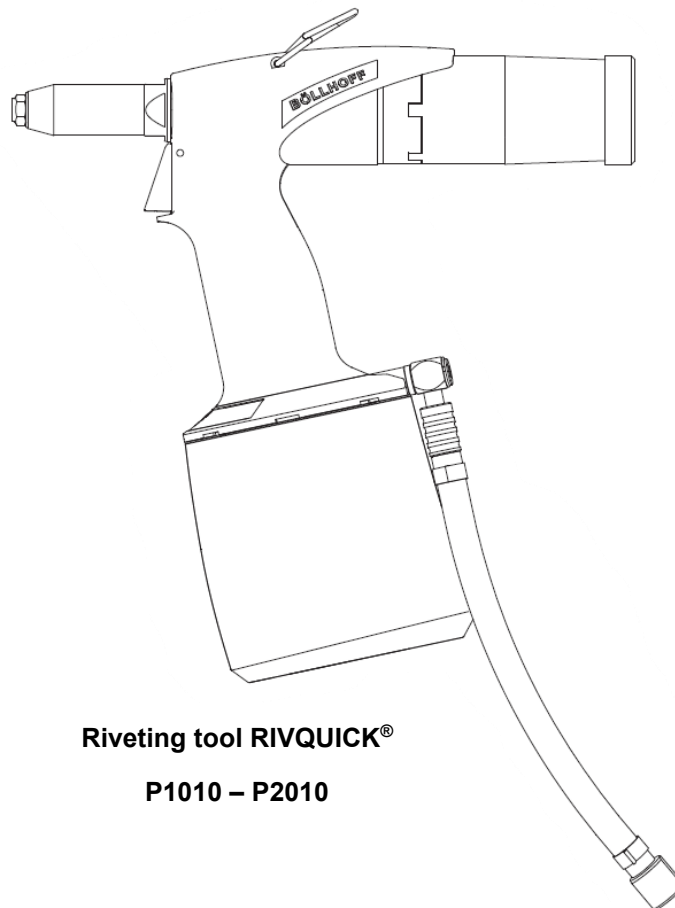

Table of Contents

1 Validity of the instruction manual	3	8.3 Maintenance at 250 000 cycles	24
1.1 Delivery contents	3	8.4 Oil check and top-up	24
2 Symbols used in the instruction manual	4	8.5 Jaws maintenance	26
2.1 Warning terms	4	8.6 Jaws position adjustment	28
2.2 Symbols indicating a danger	4	9. Split views and parts list	30
2.3 Symbols for personal protection equipment	4	10. Packaging and transport	34
2.4 Notification symbol	4	11. End-of-life management	34
2.5 Information symbols	4	12. Tool tracking sheet	36
2.6 Names, images, indices	4		
3 Use and operation	5		
3.1 Intended use	5		
3.2 Structure of the tool	5		
3.3 Operation	6		
3.4 Technical characteristics	7		
4 Safety guidelines	9		
4.1 Working conditions	9		
4.2 Personnel qualification	9		
4.3 General safety guidelines for hydro- pneumatic tools	10		
4.4 Risks associated with use of the tool	12		
4.5 Protective devices	13		
4.6 Safety signs on the tool	13		
5. Commissioning preparation	14		
5.1 Safety guidelines for commissioning preparation	14		
5.2 Nosepiece mounting	14		
5.3 Connection to compressed air supply	18		
6. Use	18		
6.1 Safety guidelines for commissioning preparation	18		
6.2 Procedure for use	19		
7. Faults, causes and solutions	20		
7.1 Safety guidelines in the event of faults	20		
7.2 Troubleshooting	20		
8. Maintenance	22		
8.1 Safety guidelines for maintenance and servicing	22		
8.2 Daily / weekly maintenance	22		

1 Validity of the instruction manual

This instruction manual is valid for the riveting tool described below, which is operated manually and is mobile.



Riveting tool RIVQUICK®
P1010 – P2010

1.1 Delivery contents

The delivery includes the following components:

- Packaging: cardboard box
- Riveting tool RIVQUICK® : P1010 or P2010
- Jaws position adjustment fork
- Flat spanner 12 / 23 mm
- Nosepieces : \varnothing 3,2 / 4 / 5 mm (P1010) – \varnothing 4 / 5 / 6 / 4.8M mm (P2010)
- Quick start guide (Quickstart)
- Safety instructions and warranty manual
- CE declaration

2 Symbols used in the instruction manual

The parts of this manual that are particularly important are highlighted by the warning terms and symbols explained below.

2.1 Warning terms

DANGER

Indicates a potential risk which, if not avoided, will cause death or serious injury.

WARNING

Indicates a potential risk which, if not avoided, could cause death or serious injury.

ATTENTION

Indicates a potential risk which, if not avoided, could cause minor or moderate injuries.

2.2 Symbols indicating a danger

Crushing



This symbol indicates that, when handling the system, there are risks to the life or health of persons due to crushing.

Risk of cutting



This symbol indicates that, when handling the system, there are risks to the life or health of persons due to cuts.

Pressurized oil spray



This symbol indicates that, when handling the system, there are risks to life or health due to pressurized oil spray.

2.3 Symbols for personal protection equipment

Use hand protection



Activities featuring this symbol require hand protection to be worn.

Use eyes protection



Activities featuring this symbol require eye protection to be worn.

Use face protection



Activities featuring this symbol require face protection to be worn.

Use hearing protection



Activities featuring this symbol require hearing protection to be worn.

Wear protective clothing



Activities featuring this symbol require protective clothing to be worn.

Wear safety shoes



Activities featuring this symbol require safety shoes to be worn.

2.4 Notification symbol

NOTE

Indicates important information (e.g., material damage) but not a danger.

2.5 Information symbols

Information



Indications preceded by this symbol will help you carry out your tasks quickly and safely.

Read the instruction manual



Before first use, it is imperative to read the instruction manual.

2.6 Names, images, indices

The RIVQUICK® P1010 – P2010 riveting tools are referred to below as "the tool".

The images are used to better understand situations and sequences. The representations may slightly deviate from the actual appearance of your system.

 The numbers in the text shown in bubbles are references that relate to the figure on the same page.

3 Use and operation

3.1 Intended use

- Do not use this tool for applications other than installing blind rivets. It is strongly recommended to use **RIVQUICK®** Böllhoff blind rivets.
- Use only fasteners, spare parts, accessories and consumables recommended by Böllhoff.
- The tool is not designed for use in explosive environments.
- The tool must be operated in compliance with its capacities and technical limits.
- This tool must be used in accordance with the labour regulations of the user country and in accordance with the principles defined by the International Labour Organization (United Nations).
- For correct functioning, check that the air inlets and outlets are clean and properly connected before use. The use of a filter / regulator / lubricator (**23659900036**) on the installation is necessary to ensure proper functioning of the tool. Never pull or hold the tool by its pneumatic hose.
- Any structural modification, transformation or an arbitrary addition to the tool is strictly prohibited.
- Any other use is deemed to be non-compliant and may be dangerous. It's also imperative to follow the instructions indicated in this instruction manual.
- Böllhoff declines all responsibility in the event of damage resulting from non-compliant use of the tool.

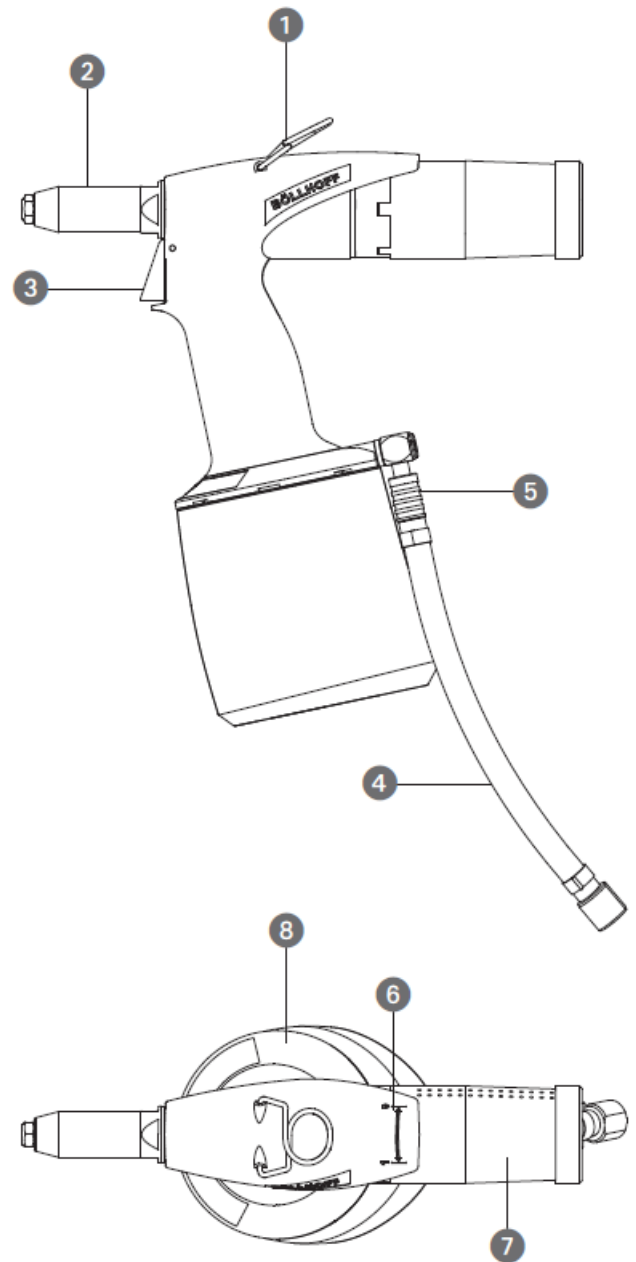

3.2 Structure of the tool

The main components of the tool are :

- Suspension hook (1)

We recommend the 2-3 kg cable balancer -

Reference: **28259010820**

- Nose (2)
- Cycle start trigger (3)
- Compressed air supply hose (4)
- Sliding valve for activation / deactivation of compressed air supply (5)

Use a compressed air supply separation device (quick coupling, valve, ...)

- Indication of activation / deactivation of broken stem suction (6)
- Broken stem collection bottle (7)
- Rotating air distribution ring (8)

3.3 Operation

DANGER



Risk of crushing and cutting!

Check that the tool is disconnected from the compressed air supply. An unexpected triggering of the riveting cycle could cause injuries.

WARNING



Risk of injury!

Working with the tool involves potential risks. Always wear safety glasses or a face shield, protective gloves, close-fitting work clothing and safety shoes.

Avantages

- Quick implementation & short cycle time
- Riveting control is simple and quick (visual)
- Preserves the appearance of surfaces even when painted
- Multi-material assembly possible including metal-plastic substrates

Purpose and usefulness of the tool :

The **RIVQUICK® P1010 & P2010** tools designed to install **RIVQUICK®** blind rivets on pre-drilled substrates and are intended for all types of industry and applications.

They allow the quick and repeatable implementation of a permanent fixing point that does not damage the substrate which can be made of different material.

The hydro-pneumatic operating principle allows the **RIVQUICK® P1010 & P2010** tools to offer an optimal weight/power ratio and to provide constant force without brutal shock during the riveting process (breaking of the stem).

It will be necessary to choose the tool model according to the diameter, the material of the rivet to be installed and according to the pulling stroke for certain blind structural rivets.

A tool selection matrix is indicated in chapters 3.4 & 5.2, do not hesitate to contact an official Böllhoff representative for any questions regarding the choice of tool mode.

When the stress is reached in the assembly, the rivet stem breaks at the breakpoint which finalizes the rivet installation cycle.

By releasing the trigger, the suction system evacuates the broken stem to the rear of the tool into the broken stem collection bottle.

The maximum riveting force developed by the **RIVQUICK® P1010 & P2010** tools are respectively 7.3 & 12.2 kN.

Implementation of a blind rivet with the **RIVQUICK® P1010, P2010 & P3010** tools.

A - Please refer to chapters 3.4 & 5.2 or contact an official Böllhoff representative to determine the appropriate tool for riveting your blind rivet.

B – Mount the nosepiece, and if necessary, the jaw pusher and the appropriate guide tube according to the diameter of the rivet to be installed.

C - Install your **RIVQUICK®** blind rivet.

3.4 Technical characteristics

Main technical characteristics of the tool

	P1010	P2010
Weight	1.44 kg	1.84 kg
Max. riveting stroke	17 mm	21 mm
Max. pulling force	7.3 kN	12.5 kN
Operating pressure	5 à 7 bars	
Air consumption / cycle	1.5 L/Cycle	2.5 L/Cycle
Ambient operating temperature	0°C / +40°C	
Tool reference	22603301000	22603401000

Declared dual-number noise emission values (In accordance with ISO 4871) on actual sound level

Portable machine tested:	
Manufacturer :	Böllhoff Otalú S.A.S
Model No.	P1010 / P2010
Type :	Hydro-pneumatic riveting tool for RIVQUICK® blind rivet
Serial No.	P1010: N° BM0001 => N°BM9999 P2010: N° BN0001 => N°BN9999
Year of Manufacture	From 2026
Operating conditions according to ISO 15744	No-load
A-weighted sound power level , L_{WA} : Uncertainty, K_{WA} :	84,4 dB (Reference 1 pW) 3 dB
A-weighted emission sound pressure level at workstation, L_{pA} : Uncertainty K_{pA} :	73.4dB (Reference 20 µPa) 3 dB
C-weighted peak emission sound pressure level, L_{pC} , peak : Uncertainty K_{pC} , peak :	102,9 dB (Reference 20 µPa) 3 dB
Note 1 :	Values determined in accordance with acoustic test code ISO 15744, using ISO 3744 and ISO 11203 as basic standards.
Note 2 :	The sum of a measured sound emission value and its associated uncertainty represent an upper limit of the range of values that can be achieved during measurements.

Vibration emission values, declaration in the absence of a vibration test code

Model No.	P1010 / P2010
Declared vibration emission value in accordance with l'EN 12096	
Measured vibration emission value, a : Uncertainty, K :	0,41 m/s ² 0.007 m/s ²
Operating conditions:	No-load

Tool dimensions

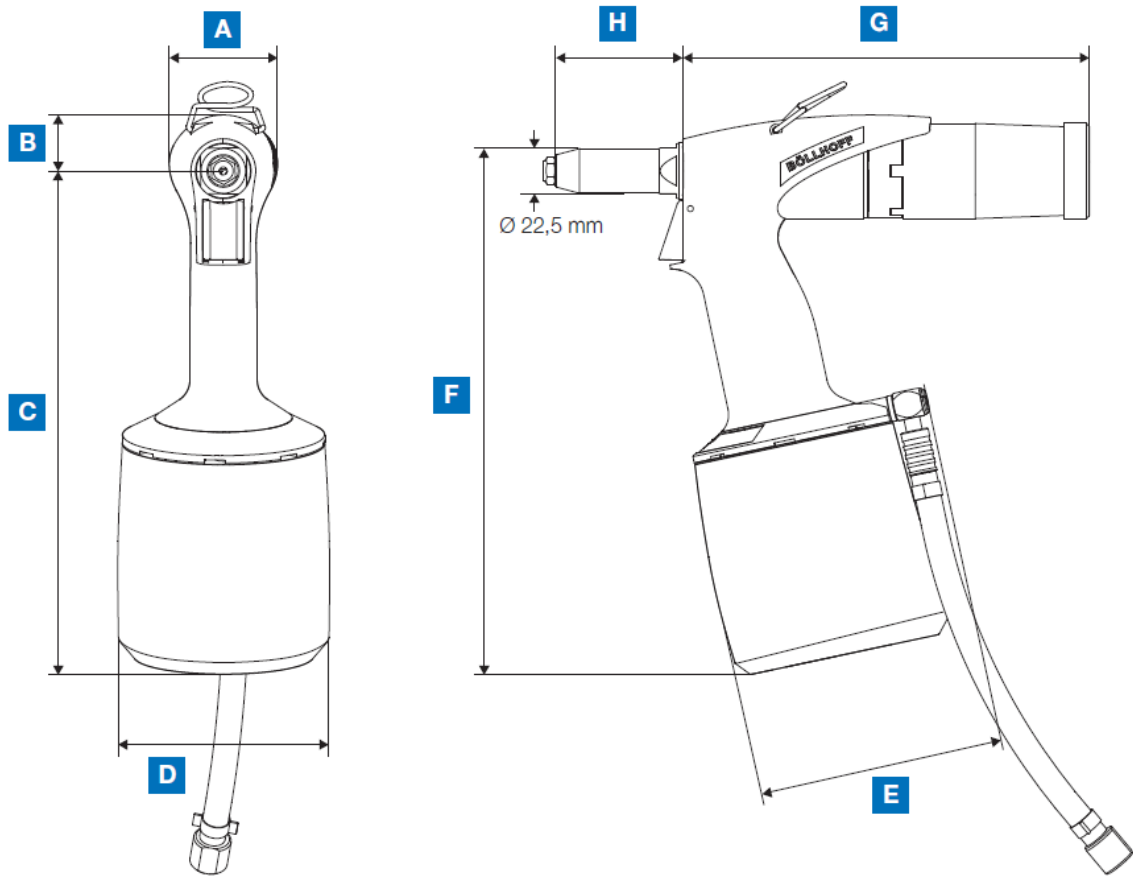

	P1010	P2010
A	50 mm / 2 in	
B	28 mm / 1,1 in	
C	240 mm / 9,4 in	254 mm / 10 in
D	79 mm / 3,1 in	108 mm / 4,2 in
E	101 mm / 4 in	120 mm / 4,7 in
F	251 mm / 9,9 in	265 mm / 10,4 in
G	210 mm / 8,2 in	
H	60 mm / 2,3 in	

Tool installation capacity

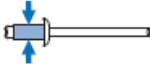
	P1010	P2010
 Ø 2,4 mm	■	
Ø 3,0 mm	■	
Ø 3,2 mm	■	
Ø 4,0 mm	■	■
Ø 4,8 mm		■
Ø 5,0 mm		■
Ø 6,0 mm		■
Ø 6,4 mm		■
RIVQUICK® Varibolt		
Ø 4,8 mm		■
Ø 6,4 mm		

4 Safety guidelines

4.1 Working conditions

WARNING



The instruction manual must always be kept at the tool's operating site and be easily accessible to operators.

The staff responsible for operating the riveting system must have read and understood the instruction manual, illustrations and specifications provided with this tool, and in particular the "Safety guidelines" chapter, before starting work.

Failure to follow the instructions listed below may result in material and/or personal injury.

WARNING



Risk of injury!

Working with the tool involves potential risks. Always wear safety glasses, protective gloves, hearing protection and close-fitting work clothing.

Spare parts must meet the technical requirements set by Böllhoff.

This is always the case when original spare parts are used.

The frequency of inspections indicated in the instruction manual must be observed.

Keep the work area and the tool clean and the area properly lit. Stay away from cluttered areas, dark areas, electrical cables, gas lines, areas with explosive atmospheres and any other phenomenon or machine that could damage the tool or cause accidents. Any limitation of the freedom of movement of operating personnel may result in malfunctions and accidents.

The tool must be protected from external influences that could cause corrosion, attack and damage components in any way, and thus hinder their operation and impair their strength.

Keep children and other persons away when using the tool. Distraction can cause the user to lose control of the tool.

4.2 Personnel qualification

Only trained operators who have understood the instruction manual and the risks involved should install, adjust or use this tool. The operator must remain vigilant and be physically capable of handling, using and transporting the tool, while respecting basic safety principles.

The operator must clearly define everyone's responsibilities regarding use, adjustment, maintenance and repair.

Trainees or persons undergoing training are only authorized to work on the tool under the permanent supervision of an experienced person. Keep this tool out of reach of persons who are not familiar with it or who do not know the instructions for operating it. Tools can be dangerous in the hands of novice users.

The various tasks to be performed with the tool require different qualifications listed in the table on the following page. The different qualifications are characterized by the following skills and knowledge :

- Operators must be able to replace and mount a nosepiece or modify its equipment, as well as operate the tool. They must detect any damage to the tool and the hazards associated with it.
- Adjusters, in addition to the capabilities specific to operators, must be able to adjust the position of the jaw housing and also be capable of checking the pulling stroke at regular intervals.

Read the table on page 10 as follows, for example:

« Mounting the nosepiece requires operator qualifications».

« Troubleshooting, repairs and maintenance work must be carried out by a Böllhoff after-sales service technician».

	Operator	Adjuster	Böllhoff ASS technician
Use	■	■	■
Cleaning	■	■	■
Emptying the broken stem collection bowl	■	■	■
Mounting / replacement of the nosepiece	■	■	■
Mounting / replacement of the jaws		■	■
Checking the pulling stroke		■	■
Adjustment of the jaw position		■	■
Troubleshooting according to chapter 7-2 - Pages 21 to 23		■	■
Troubleshooting, repair and maintenance			■

4.3 General safety guidelines for hydro-pneumatic tools

⚠ WARNING



Read all safety warnings, instructions, illustrations and technical specifications provided with this hydro-pneumatic tool. Failure to comply with the following instructions may result in serious injury. Keep all safety instructions and all instructions for future reference.

The term "hydro-pneumatic tool" used in the safety instructions refers to tools powered by compressed air but whose pulling force is hydraulic. Tools can be dangerous in the hands of novice users who are not familiar with them or who do not know the instructions for operating them.

Individual safety

▪ **Be vigilant, pay close attention to what you are doing and work as reasonably as possible with a hydro-pneumatic tool.**

Do not use a hydro-pneumatic tool if you are tired, under the influence of drugs, alcohol or medication. A moment of inattention during use of the tool can result in serious injury.

▪ **Wear personal protective equipment and always safety glasses or a face shield.**

⚠ WARNING



Wearing personal protective equipment such as non-slip safety shoes, helmet or hearing protection, depending on the type and implementation of the hydro-pneumatic tool, reduces the risk of injury.

▪ **Avoid any unintentional start-up.**

Ensure that the hydro-pneumatic tool does not have the cycle start trigger activated and that the broken stem collection bottle is mounted before connecting it to the compressed air supply, picking it up or carrying it. An accident may occur if the cycle start trigger is

activated and the broken stem collection bottle is not mounted while you are carrying the tool, if it is connected to the compressed air supply.

- Avoid any abnormal posture. Ensure the stability of your position and keep your balance at all times. This allows you to have better control of the hydro-pneumatic tool in case of unexpected situations.
- Wear appropriate clothing. Do not wear loose clothing or jewellery. Keep your hair and clothing away from moving parts. Loose clothing, jewellery or long hair can be caught by moving parts.
- Do not be deceived by a false sense of security and continue to feel concerned by safety rules, even if repeated use has made the hydro-pneumatic tool familiar to you. Any negligence in handling can, in a fraction of a second, result in serious injury.

⚠ DANGER

Be aware that the breakage of a part, accessory or the tool itself can generate high-speed projectiles or sudden shocks on the tool handle.

Preliminary checks

⚠ WARNING

Before any use, perform all necessary checks defined in this instruction manual.

- Check for the absence of :
 - Misalignment or jamming of moving parts.
 - Breakage of parts, damage, visible impact marks or cracks.
 - Abnormal behaviour or parts moving against each other.
 - Oil leak or oil traces.
- Ensure that the various parts and guards of the tool are securely fastened. In case of problems, stop using the tool and have it repaired by a service qualified by Böllhoff.

- Perform the oil level and jaw wear check at the frequency defined in the maintenance section. Insufficient oil level can affect the installation quality and damage the tool.
- Do not use the tool if the compressed air supply valve, trigger, stem collection bowl are blocked or show operating anomalies. Any tool that cannot be properly controlled can be dangerous and must be repaired by a Böllhoff qualified workshop.
- Remove any adjustment tool or flat wrench before use.
- If the tool is attached by its suspension ring, ensure that the attachment is secure.

Instructions for use

- Do not use the tool in the direction of a person.
 - Ensure that no object can get stuck in the tool mechanism.
- Stop using the tool immediately when an object is inadvertently stuck or when it is blocked. Disconnect the tool from the compressed air supply, identify the source of the problem and carefully extract it.
- Do not use the tool if the nose or guards are removed.
 - Stop using the tool if you experience recurring or persistent discomfort, pain, numbness and/or stiffness. Inform the employer and consult an occupational physician.
 - Keep the handle, nose and tool surface clean, dry and free of oil or grease. Do not expose the tool to rain, liquid splashes or dust. In unexpected situations, slippery handles and gripping surfaces make it impossible to handle and control the tool safely.
 - Keep fingers and hands away from the **RIVQUICK®** pinch zone.
- If the **RIVQUICK®** is manually inserted into the nosepiece, fingers should be placed at the end of the **RIVQUICK®** body. They should not touch the **RIVQUICK®** head to avoid pinching.
- Do not force the tool or abuse it by dropping it, using it as a hammer or applying abnormal pushing or pulling force. Proper use of the tool allows you to work more efficiently and safely at the rate and use for which it was designed..

Maintenance and repair

- A hydro-pneumatic tool can, by its nature, cause serious injury if maintenance is not carried out according to the maintenance plan.

In all cases, never open your Böllhoff tool as the product may be under pressure even if it is disconnected from the compressed air supply. If the tool needs to be opened, please return it to a repair

- center qualified by Böllhoff, as only Böllhoff personnel have the necessary experience to open a pressurized tool.
- Have the tool repaired at a repair center qualified by Böllhoff that uses only original spare parts. This ensures that the tool is kept safe.
 - Disconnect the tool from the compressed air supply before changing accessories, adjusting the jaw position, performing maintenance, mounting or removing the nose.
 - Do not modify the tool in any way. Unintended modifications may reduce the effectiveness of safety systems and increase risks to the operator.
 - The tool must be kept in good working order and safe at all times. It must be regularly inspected by qualified personnel to detect any damage or malfunction. Maintenance must be carried out at the frequency defined in this instruction manual. A complete safety check of the tool must be carried out at least every 250,000 cycles or every 2 years, whichever comes first. Do not disassemble this tool yourself, have it repaired at a Böllhoff qualified repair center. Many accidents are caused by poorly maintained tools.
 - Use only the lubricants and oils recommended in this instruction manual.

Air supply

- Do not exceed the maximum pneumatic pressure indicated on the machine: 7 bar - 100 psi.
- Compressed air can cause serious injury:
 - Always disconnect the tool from the compressed air supply when not in use or during adjustments and accessory changes.
 - Never direct the air flow towards yourself or another person.
 - Always check that hoses and fittings are tight and in good condition.
 - Keep hands and arms away from air exhaust holes.
 - Never move the tool by holding it by its pneumatic supply hose.
- For correct operation, check that the air inlet and outlet are clean and properly connected before use. The use of a filter / regulator / lubricator on the installation is necessary to ensure proper operation of the tool in accordance with warranty conditions.
- Do not block or cover air exhaust ports.

4.4 Risks associated with use of the tool

The tool must be used only :

- for the purpose for which it was designed,
- in perfect working order,
- with full knowledge of safety instructions and risks involved.

Do not use the tool if you notice malfunctions that endanger safety.

DANGER

Risk of part ejection!

The breakage of a part, accessory or the tool itself can generate high-speed projectiles or sudden shocks on the tool handle.

Before any use, perform all necessary checks defined in this instruction manual.

Check for the absence of ::

- Misalignment or jamming of moving parts.
- Breakage of parts, damage, visible impact marks or cracks.
- Abnormal behavior or parts moving against each other.
- Leak, traces, oil seepage.

DANGER



Risk of pressurized oil spray!

Never use the tool at an operating pressure above 7 bar (100 psi). Using the tool at an operating pressure above 7.5 bar (110 psi) can cause structural parts to break and generate high-speed projectiles or pressurized oil spray.

DANGER



Never disassemble the nose when the tool is connected to the compressed air supply. Maintenance or replacement operations of the jaws and adjustment of the jaw position must be carried out with the tool disconnected from the compressed air supply (except during the nosepiece change/replacement operation described in paragraph 5.2).

When inserting the RIVQUICK® into the nosepiece, the RIVQUICK® must be held at its end by the fingertips, do not place your fingers between the RIVQUICK® head and the nosepiece. The use of suitable gloves is mandatory.

DANGER



Never trigger the riveting cycle when the RIVQUICK® is not positioned in the application hole and is held with your fingers or hands, even when wearing gloves. Always be vigilant not to trigger the riveting cycle inadvertently.

DANGER

Risk of injury!

Fatigue or excessive effort caused by repetitive movements in an ergonomically unfavourable posture can lead to injuries.

- Ensure you have a comfortable and stable position when using the too.
- Make sure to change position when working for long periods.

WARNING

Risk of falling!

Untidy connection elements or incorrect posture represent a risk of falling.

- Keep the environment in which the tool is used clean and tidy.
- Ensure your stability and keep your balance when using the tool.
- Be ready to counterbalance any movement of the tool or the part in which you are going to install the RIVQUICK® blind rivet.

4.5 Protective devices

⚠ WARNING

Protective devices serve to ensure the safety of personnel working with the tool and to preserve their health; they also serve to protect the tool against possible damage. If you notice that protective devices are damaged, do not use the tool.

The tool is equipped with the following protective devices:

- Nose (1)
- Rubberized tank protection (2)
- Broken stem collection bottle with rubberized rear protection (3)
- Compressed air activation / deactivation valve (4)

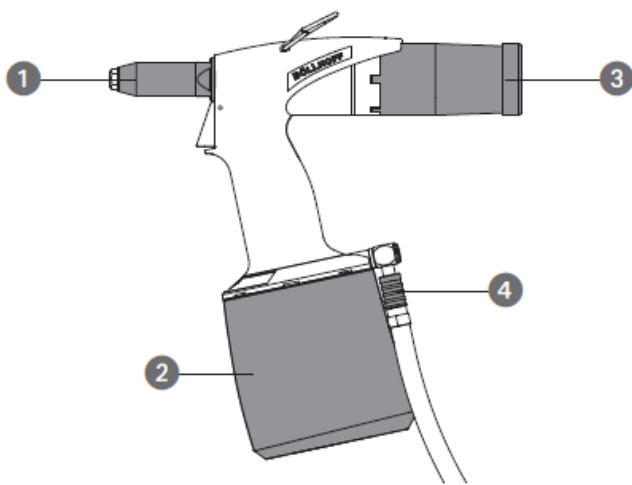

4.6 Safety signs on the tool

(1) This value indicates the operating pressure to be observed. Unit: Bar.

(2) This symbol indicates that it is necessary to read and follow the instruction manual.

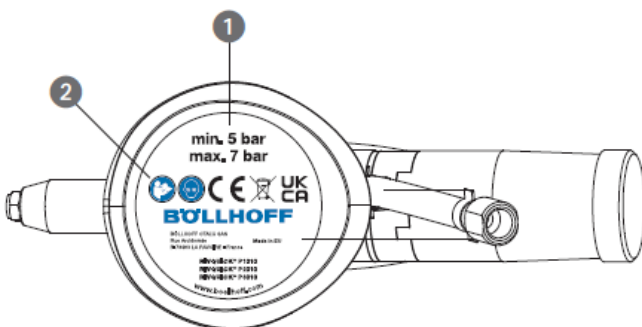

5. Commissioning preparation

5.1 Safety guidelines for commissioning preparation

⚠ DANGER



Risk of crushing and cutting!

Check that the tool is disconnected from the compressed air supply. An unexpected triggering of the riveting cycle could cause injuries.

⚠ DANGER



Risk of part ejection!

Risk of pressurized oil spray!

The use of the tool at a pressure above 7 bar (100 psi) is strictly prohibited and may cause serious injury.

⚠ WARNING



Working with the tool involves potential risks. Always wear safety glasses, protective gloves, close-fitting work clothing and safety shoes.

! NOTE

Please carefully choose the nosepiece compatible with the RIVQUICK® blind rivet to be installed.

This choice is made mainly according to the diameter of the body and the material of the RIVQUICK® blind rivet.

For small diameter RIVQUICK® blind rivets (ø2.4 & 3 mm) the diameter of the RIVQUICK® blind rivet stem can also be considered when choosing the nosepiece (See "List of standard nosepieces").

As the nosepiece is one of the main wear parts, it is advisable to establish a frequency for inspection or replacement.

Nosepieces for RIVQUICK® VARIBOLT must be visually inspected at regular intervals, particularly at the body/stem riveting lip which is located around its hole.

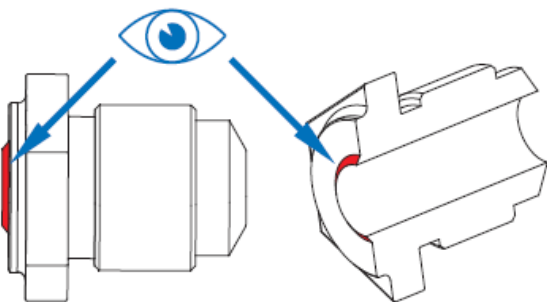

5.2 Nosepiece mounting

>>> Quickstart fig. 3

⚠ DANGER

Tool under pressure!

The pneumatic supply must be connected to the compressed air supply to carry out the operations below, make sure to work with adequate personal safety equipment. Ensure that the tool is equipped with components that protect moving parts (Nose, broken stem collection bottle, etc).

Nosepiece mounting

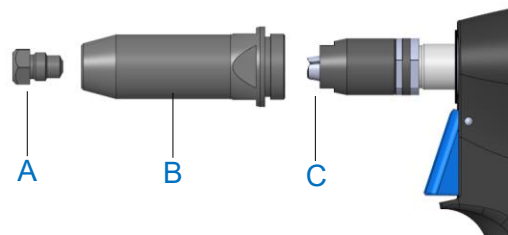

Connect the tool to compressed air

- 1- Press the trigger and maintain this pressure throughout the nosepiece mounting operation (A).
- 2- Using the special wrench provided or a 12 mm open-end wrench, screw the nosepiece (A) onto the nose (B). Apply a torque of 10 N.m. (This tightening will also tighten the nose (B) on the tool).
- 3- Release the trigger.



Nosepieces are supplied Mounted on the special 23/12 mm spanner provided With the tool.

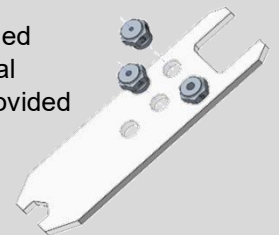



! NOTE

Necessary functional play between the RIVQUICK® blind rivet stem and the nosepiece hole :

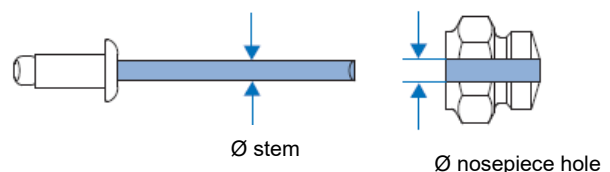

Ø Nosepiece hole - Ø stem = 0,1 mm mini à 0,4 mm maxi

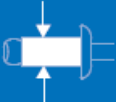

List of nosepieces

	Body Material	Stem Material	Nose-tip p/n		\varnothing (mm mini)	P1010	P2010
STANDARD							
2,4	Aluminium	Steel	22603024001	2.4	1,9	■	
	Steel	Steel					
	Stain. steel	Stain. steel					
	Aluminium	Stain. steel					
	Aluminium	Aluminium					
3	Aluminium	Aluminium	22603032001	3.2	2,3	■	
	Aluminium	Steel				■	
	Steel	Steel				■	
	Stain. steel	Stain. steel				■	
	Aluminium	Stain. steel				■	
3,2	Aluminium	Aluminium	22603032001	3.2	2,3	■	
	Aluminium	Steel				■	
	Steel	Steel				■	
	Stain. steel	Stain. steel				■	
	Aluminium	Stain. steel				■	
4,0	Aluminium	Aluminium	22603040001	4	2,8	■	■
	Aluminium	Steel				■	■
	Steel	Steel				■	■
	Stain. steel	Stain. steel				■	■
	Aluminium	Stain. steel				■	■
4,8	Aluminium	Aluminium	22603050001	5	3,3	■	■
	Aluminium	Steel				■	■
	Steel	Steel					■
	Stain. steel	Stain. steel					■
	Aluminium	Stain. steel					■
5,0	Aluminium	Aluminium	22603050001	5	3,3		■
	Aluminium	Steel					
	Steel	Steel					
	Stain. steel	Stain. steel					
	Aluminium	Stain. steel					
6,0	Aluminium	Aluminium	22603160001	6	3,9		■
	Aluminium	Steel					■
	Steel	Steel					■
	Stain. steel	Stain. steel					
	Aluminium	Stain. steel					
6,4	Aluminium	Aluminium	22603164001	6,4	4,3		■
	Aluminium	Steel					■
	Steel	Steel					
	Stain. steel	Stain. steel					
	Aluminium	Stain. steel					

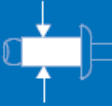
List of special nosepieces

	Body Material	Stem Material	Nose-tip p/n		\varnothing (mm mini)	P1010	P2010
VARIGRIP							
3,2	Aluminium	Steel	22603032001	3	2,3	■	■
	Aluminium	Stain. steel				■	■
	Stain. steel	Stain. steel				■	■
4,0	Aluminium	Steel	22603040001	4	2,8	■	■
	Aluminium	Stain. steel				■	■
	Stain. steel	Stain. steel				■	■
4,8	Aluminium	Steel	22603050001	5	3,3	■	■
	Stain. steel	Stain. steel					■
VARIBOLT							
4,8	Steel	Steel	22603148001	4,8M	3,05		■
	Stain. steel	Stain. steel					■
6,4	Steel	Steel	22603264001	6,4M	4,15		
	Stain. steel	Stain. steel					
VARIBULB							
3,2	Steel	Steel	22603032001	3	2,3	■	■
	Stain. steel	Stain. steel				■	■
4,0	Steel	Steel	22603040001	4	2,8	■	■
	Stain. steel	Stain. steel				■	■
4,8	Steel	Steel	22603050001	5	3,3		■
	Stain. steel	Stain. steel					■
6,4	Steel	Steel	22603164001	6,4	4,3		
	Stain. steel	Stain. steel					
VARIBOLT+							
6,4	Steel	Steel	22603164001	6,4	4,3		
	Aluminium	Aluminium					
VARILOCK							
6,4			22603164001	6,4	4,3		

Extended nosepieces (not included with the tool)

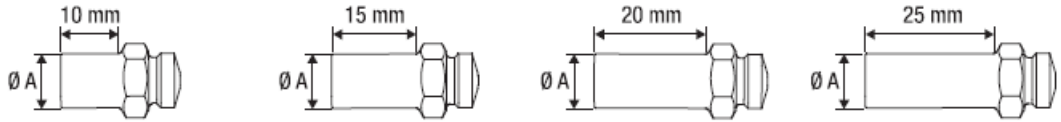

STANDARD L=6 mm	ØA (mm)	L +10 mm	L +15 mm	L +20 mm	L +25 mm
		Ø 2.4	5	22603024101/00	22603024151/00
Ø 3.2	6	22603032101/00	22603032151/00	22603032201/00	22603032251/00
Ø 4.0	7	22603040101/00	22603040151/00	22603040201/00	22603040251/00
Ø 5.0	8	22603050101/00	22603050151/00	22603050201/00	22603050251/00
Ø 6.0	9	22603060101/00	22603060151/00	22603060201/00	22603060251/00
Ø 6.4	10	22603064101/00	22603064151/00	22603064201/00	22603064251/00

NOTE

Extended nosepieces require rivets with stems longer than standard: Before placing any order, contact a Böllhoff representative to help you choose the rivet compatible with the nosepiece length.

Extended noses (Not included with the tool)

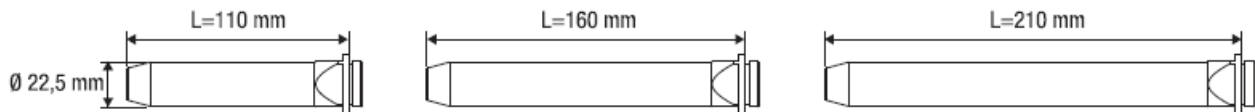

L	TOOL	Référence
110 mm	P1010	22603000110/00
	P2010	22603100110/00
160 mm	P1010	22603000120/00
	P2010	22603100120/00
210 mm	P1010	22603000130/00
	P2010	22603100130/00

NOTE

The listed long nose references are supplied as a kit including: the nose, the extended guide tube and the piston extension.

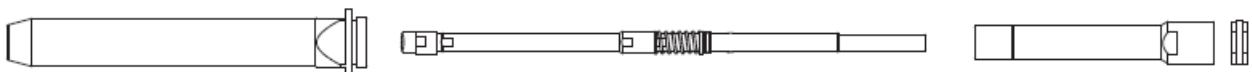

5.3 Connection to compressed air supply

>>> Quickstart fig. 1

NOTE

The tool is powered by compressed air at an optimal pressure of **6 bar (90 psi)**. The operating pressure ranges from **5 bar (70 psi) to 7 bar (100 psi) maximum**.

ATTENTION

Below 5 bar (70 psi) the operation of the tool may be degraded.

Use a compressed air supply separation device (quick coupling, valve, etc. ...).

We recommend using the Filter Regulator Lubricator (FRL) reference **23659900036**, on your compressed air network to optimize the life of your tool and ensure user safety.

NOTE

The air hose connecting the tool to the compressed air supply must not exceed a length of 3 meters (120 inches) to ensure optimal tool life and minimum maintenance.

The air hose must have an internal diameter of **6.4 mm (1/4")** minimum. A quick coupling and/or compressed air shut-off valve must be accessible to the user.

ATTENTION

An over-lubricated compressed air network containing water, impurities or overpressure can seriously damage the tool. Do not use oil containing silicone. We advise you to set the lubrication flow rate of your FRL to 1 drop/minute.

6. Use

6.1 Safety guidelines for commissioning preparation

DANGER



Risk of crushing and cutting!

When riveting the RIVQUICK®, be very vigilant: an unexpected triggering of the riveting cycle could cause injuries.

Place your fingers at the end of the RIVQUICK® when inserting it into the nosepiece, remain vigilant during the riveting operation.

WARNING



Working with the tool involves potential risks. Always wear safety glasses, protective gloves, close-fitting work clothing and safety shoes.

WARNING

Only trained, qualified and experienced operators who have understood the instruction manual and the risks involved should install, adjust or use this too.

The operator must remain vigilant and be physically capable of handling, using and transporting the tool while respecting basic safety principles.

6.2 Procedure for use

>>> Quickstart fig. 5

⚠ DANGER

Tool under pressure!

The pneumatic supply must be connected to the compressed air supply to carry out the operations below, make sure to work with adequate personal safety equipment. Ensure that the tool is equipped with components that protect moving parts (Nose, broken stem collection bottle, etc ...).

Placing the RIVQUICK® blind rivet

- 1- Ensure that the tool suction is active by positioning the broken stem collection bottle on mark "1" (By rotating 1/4 turn), then insert the RIVQUICK® blind rivet stem into the tool nosepiece. The RIVQUICK® blind rivet head must be in contact with the tool nosepiece.
- 2- Insert the RIVQUICK® blind rivet mounted on the tool into the application hole.

! NOTE

During all the following operations, ensure to maintain good perpendicularity between the tool nose and the application.

Riveting the RIVQUICK® blind rivet

- 3- Press the trigger to start the riveting cycle until the RIVQUICK® blind rivet stem breaks (characteristic noise).
- 4- Release the trigger, the hydraulic piston returns to initial position.

Evacuation of the RIVQUICK® blind rivet

- 5- The broken stem of the RIVQUICK® blind rivet is automatically evacuated by suction into the broken stem collection bottle located at the rear of the tool.

! NOTE

Please empty the broken stem collection bottle at regular intervals. The filling level of the bottle must not exceed the broken stem outlet hole.

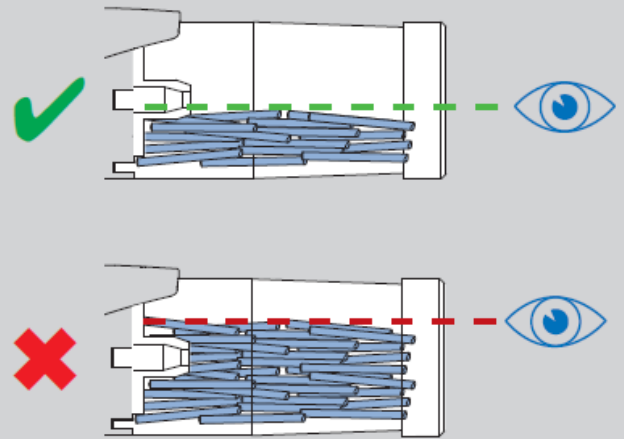

7. Faults, causes and solutions

7.1 Safety guidelines in the event of faults

⚠ WARNING

Only personnel with the required qualifications are authorized to carry out repairs. In case of failure, stop the tool immediately. Have the fault corrected without delay.

Before starting work, disconnect the tool from the compressed air supply. Otherwise, you risk injury. If during an intervention you have had to loosen a screwed element, make sure to tighten it correctly while respecting the tightening torque when specified.

⚠ WARNING



Working with the tool involves potential risks. Always wear safety glasses, protective gloves, close-fitting work clothing, hearing protection and safety shoes.

7.2 Troubleshooting

Problem	Probable causes	Solutions
SUCTION		
Little or no suction	1. Air connection "ON/OFF" ring in "OFF" position.	1. Put the ring in "ON" position.
	2. Broken stem collection bottle in position "0" or absent.	2. Mount the broken stem collection bottle, turn it to position "1".
	3. Broken stem stuck in the guide tube.	3. Disassemble the guide tube and extract the stuck broken stem.
	4. Too much oil in the tool (incorrect hydraulic piston position).	4. Purge the tool and refill with oil (Chapter 8.4).
	5. Incorrect jaw position adjustment.	5. Adjust the jaw position (Chapter 8.6).
	6. Nosepiece and/or jaws clogged.	6- Disassemble and clean the nosepiece and/or jaws (Chapter 5.2 and 8.5).
Blowing instead of sucking	1- Defective guide tube.	1- Disassemble the guide tube and check the presence and condition of its O-ring (P1010 and P2010).
	2- Guide tube blocked.	2- Disassemble and check that broken stems are not stuck inside the guide tube.

! NOTE

If several broken stems are stuck inside the guide tube, do not try to remove them, replace the guide tube.

⚠ WARNING

If the tool malfunctions due to excessive oil volume, stop using it immediately: the risk of damage or injury is significant. Perform a complete oil purge and refill according to the procedure described in chapter 8.4.

Problem	Probable causes	Solutions
RIVETING		
Impossible to insert the rivet into the nosepiece	1. Unsuitable nosepiece.	1. Check that the diameter engraved on the nosepiece is suitable for the rivet diameter (Chapter 5.2).
	2. Worn nosepiece.	2. Disassemble the nosepiece and check the condition of the rear cone, replace if necessary.
	3. Nosepiece and/or nose poorly tightened.	3. Tighten the nosepiece to 10 Nm in contact with the nose and/or tighten the nose to 10 Nm in contact with the tool.
	4. Too much oil in the tool (hydraulic piston too far back).	4. Purge and refill with oil (Chapter 8.4).
	5. Clogged jaws	5. Clean and reassemble the jaws (Chapter 8.5).
	6. Broken stem stuck in the jaws.	6. Disassemble the jaws and extract the stuck broken stem.
No riveting or riveting in multiple cycles	1. Collection bottle too full.	1. Empty the collection bottle (Quickstart chapter 5 & Instruction manual chapter 6.2).
	2. Unsuitable nosepiece.	2. Check that the diameter engraved on the nosepiece is suitable for the rivet diameter (see chapter 5.2).
	3. Worn nosepiece	3. Disassemble the nosepiece and check the condition of the rear cone, replace if necessary (Chapter 5.2).
	4. Stem stuck in guide tube.	4. Disassemble the guide tube and replace it.
	5. Poor perpendicularity of the tool relative to the support during riveting (deformation of the rivet stem).	5. Ensure good perpendicularity relative to the support during the riveting phase (Quickstart chapter 5 & Instruction manual chapter 6.2).
	6. Riveting in multiple cycles (deformation of the rivet stem).	6. See section "No riveting or Riveting in multiple cycles".
Unusually long riveting cycle	1. Pneumatic tank unscrewed	1 Tighten properly the pneumatic tank.

! NOTE

If the function could not be restored, please contact an authorized Böllhoff repair center or your maintenance service, if it has received training approved by Böllhoff.

8. Maintenance

NOTE

The various maintenance operations depend on the use of the tool. Contact an authorized Böllhoff representative to assess the frequency of maintenance operations to be performed.

8.1 Safety guidelines for maintenance and servicing

DANGER

Tool under pressure!

The pneumatic supply must be disconnected from the compressed air supply before any servicing or maintenance operation.

WARNING

Tool maintenance must be entrusted to persons who have received appropriate training from an authorized Böllhoff technician.

Given the hydraulic pressure developed by the tool, risks of injury can be caused by inappropriate maintenance operations carried out by unqualified personnel.

Any maintenance operation not authorized by Böllhoff during the warranty period will automatically void it.

WARNING



Working with the tool involves potential risks. Always wear safety glasses, protective gloves, close-fitting work clothing, hearing protection and safety shoes.

8.2 Daily / weekly maintenance

OPERATION	FREQUENCY
Check that there are no leaks on the pneumatic hose, pneumatic connectors, on the tool surface.	<ul style="list-style-type: none"> ▪ 1 time / day ▪ At each shift start ▪ After maintenance ▪ After a tool drop ▪ After using unauthorized operating pressure
<p>Check, when the tool is in use, that there is no unusual movement between its various mechanical and structural elements (for example between the body and the tank).</p> <p>Check, when the tool is operating, that it does not emit unusual noises, other than those inherent to its use (No cracking, friction noises for example).</p> <p>! If you detect the presence of a hydraulic leak, stop using the tool immediately.</p>	<ul style="list-style-type: none"> ▪ 1 time / day ▪ At each shift start ▪ After maintenance ▪ After a tool drop ▪ After using unauthorized operating pressure
Clean and grease the jaws and jaw housing, check the condition of the jaws and guide tube (Chapter 8.5).	<ul style="list-style-type: none"> ▪ 1 time / week
Check the condition of the nosepiece and that it is suitable for the rivet to be installed (Chapter 5).	<ul style="list-style-type: none"> ▪ At each shift start ▪ At each rivet reference change ▪ 1 time / day
Check the condition of the broken stem collection bottle: check that it is locked and cannot be removed when in position "1".	<ul style="list-style-type: none"> ▪ At each shift start ▪ After a drop ▪ 1 time / day
Check that the broken stem collection bottle is emptied regularly and that the quantity of accumulated broken stems does not exceed the specified level (Quickstart chapter 5 & Instruction manual chapter 6.2).	<ul style="list-style-type: none"> ▪ At shift start ▪ Regularly during production
Check that the pneumatic tank is not unscrewed.	<ul style="list-style-type: none"> ▪ 1 time / day ▪ At each shift start ▪ After servicing, maintenance ▪ After a tool drop

OPERATION	FREQUENCY
Check that the tool has not been dropped by visually inspecting for marks or impacts on its surface.	<ul style="list-style-type: none"> ▪ 1 time / day ▪ At each shift start ▪ After servicing

⚠ DANGER

Tool under pressure!

The pneumatic supply must be connected to the compressed air supply to carry out the operations below, make sure to work with adequate personal safety equipment. Ensure that the tool is equipped with components that protect moving parts (Nose, broken stem collection bottle, etc...).

Check the "in air" operation of the tool equipped with its nose and nosepiece (complete cycle). Check that the suction works correctly (broken stem collection bottle in position 1).	<ul style="list-style-type: none"> • At each shift start • 1 time / day • After a drop • After servicing
Check the operating pressure of the line to which your tool is connected, adjust to the pressure recommended by Böllhoff if necessary (chapter 5.3).	
Check the FRL that supplies air to the tool (lubrication flow rate, presence of water or impurities in the filter bowl). In all cases, follow the manufacturer's recommendations.	<ul style="list-style-type: none"> • 1 time / week

⚠ WARNING

If you detect the presence of a pneumatic and/or hydraulic leak, stop using the tool immediately.

8.3 Maintenance at 250 000 cycles

We strongly recommend having the tool completely disassembled every 250,000 cycles (or every 2 years) by a person who has received qualifying training from a Böllhoff representative. Dynamic components, worn or damaged hydraulic and pneumatic sealing elements must be replaced.

Special tool kit reference 22603000400/00

This tool kit can only be sold following training provided by an authorized Böllhoff organization. Please contact a Böllhoff representative for more information.

8.4 Oil check and top-up

DANGER



Risk of pressurized oil spray!

Check that the tool is disconnected from the compressed air supply before unscrewing the pneumatic tank. An unexpected triggering of the riveting cycle could cause pressurized oil spray and serious injury. Even in the absence of air supply, residual pressure may persist and cause oil spray.

ATTENTION

An oil level that is too low or too high can cause malfunctions, it is important to follow this procedure.

NOTE

We recommend checking the oil level of your tool once a week, using the procedure described below.

Please use only mineral oil with a viscosity grade of 32. The oil must be clean, free of particles and must not contain silicone.

A step-by-step procedure describing the oil filling is available in the "service / Technical Forum" section of the Böllhoff website :



Universal oil filling kit RIVQUICK® P1010 / P2010
 Reference : 22603000450/00

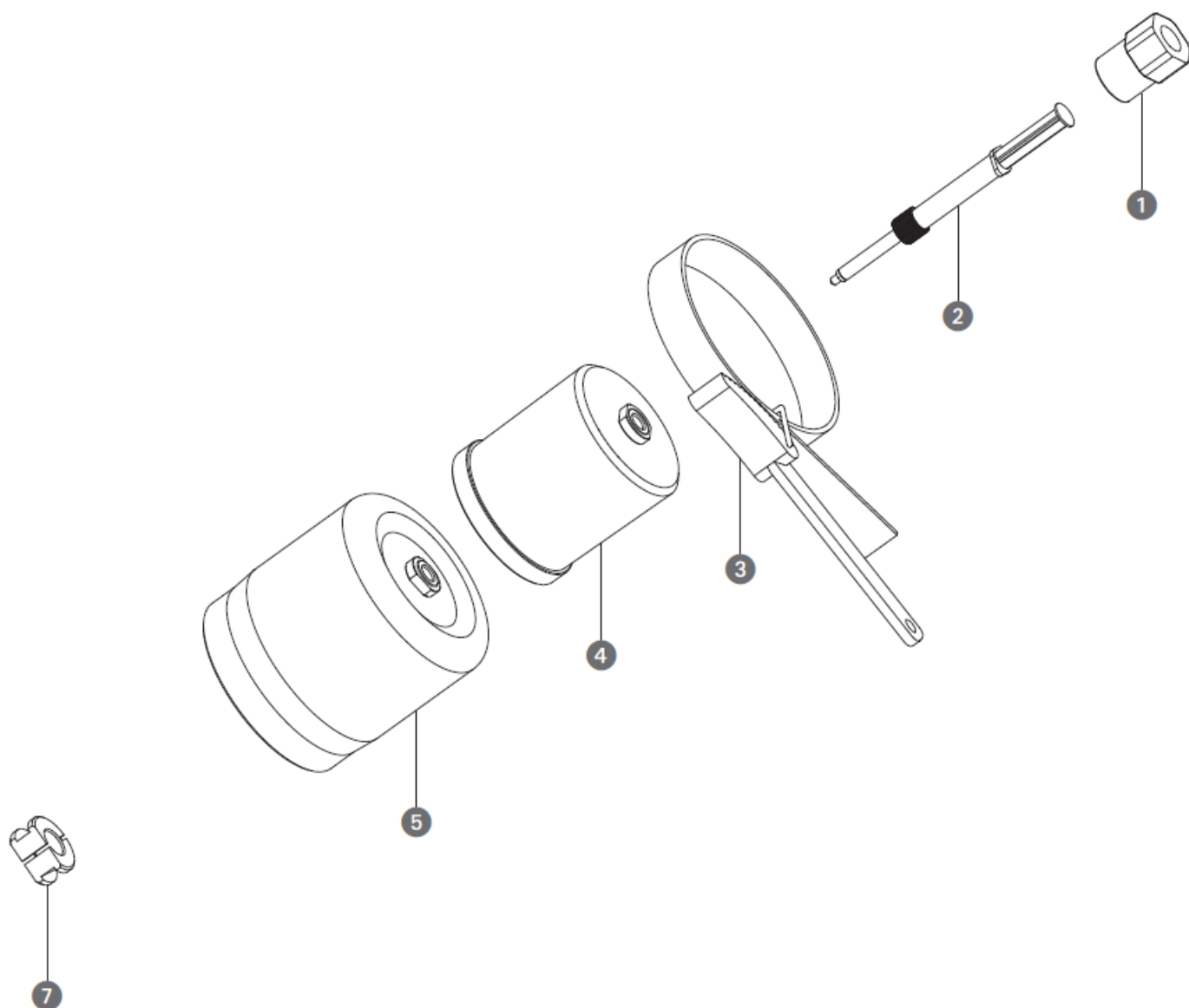

	Code	Description	Reference	Qty
1	MP50	Piston locking nut	22603000424	1
2	MP13	Syringe	22603000411	1
3	MP14	Belt wrench	22603000412	1
4	MP19	Dummy tank P1010	22603000415	1
5	MP20	Dummy tank P2010	22603000416	1
7	MP15A	Pneumatic piston clamp	22603000413	1

8.5 Jaws maintenance

⚠ DANGER



Risk of crushing and cutting!

When servicing the tool jaws, be very vigilant, an unexpected triggering of the riveting cycle could cause injuries.

⚠ DANGER

Tool under pressure!

The pneumatic supply must be disconnected from the compressed air supply before any servicing or maintenance operation.

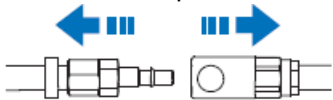

Disconnect the tool from the compressed air supply before starting the jaws cleaning procedure.

⚠ ATTENTION

Dirty or excessively worn jaws can greatly reduce tool performance during the riveting phase or evacuation of broken stems. We recommend checking and maintaining the jaws once a week, using the procedure described below.

Please use only molybdenum disulfide grease type MOS2 which is specially adapted to metal/metal friction and is insensitive to the heat that this friction can generate.

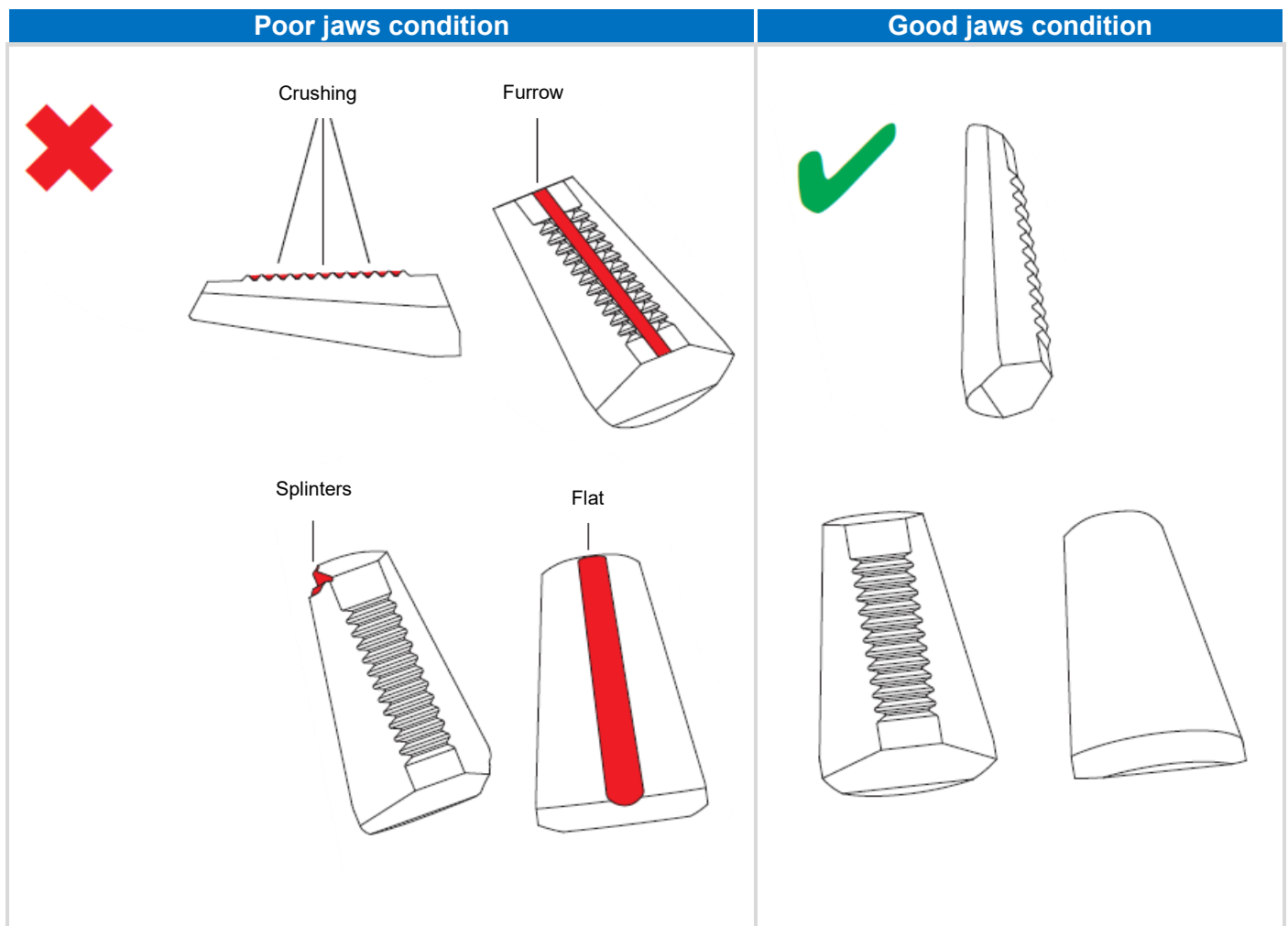

- 1 Using the special spanner provided, unscrew and remove the nose.

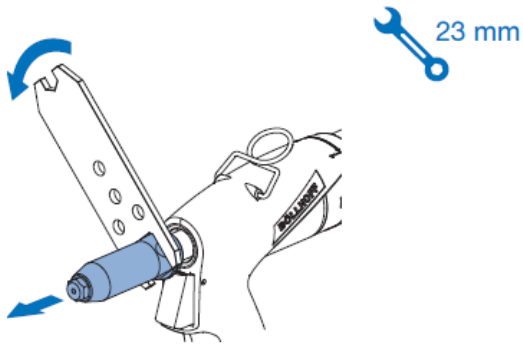

- 2 Using 2 flat and thin 17mm spanners, unscrew the jaw housing and the 3 jaws.

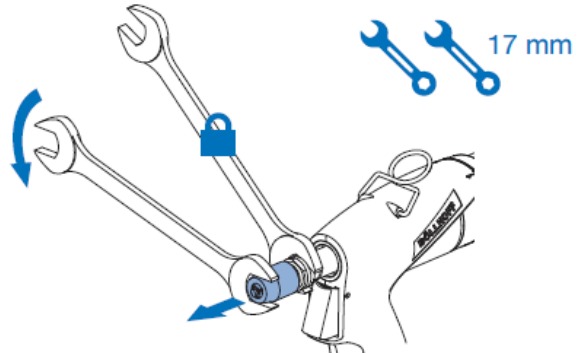

- 3 Remove the 3 jaws from the jaw housing.

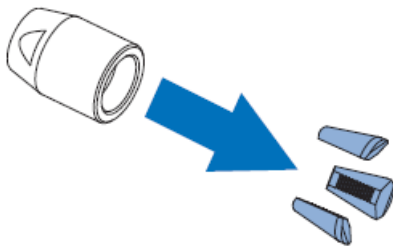

- 4 Apply degreaser on the jaws and clean them thoroughly by scrubbing with a wire brush.

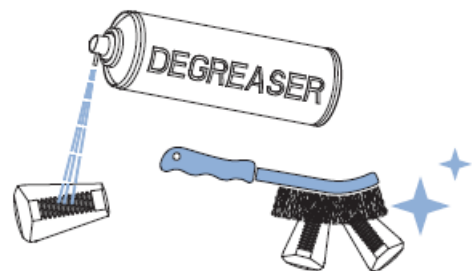

- 5 Apply a degreaser in the jaw housing and clean it thoroughly with a cloth.

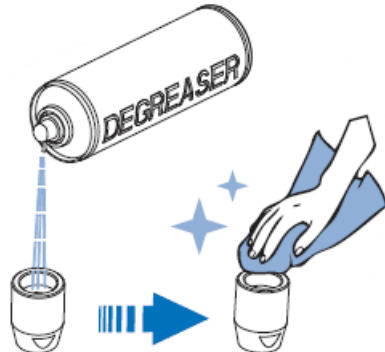

- 6 Apply a thin layer of MOS2 type grease to the surface of the internal cone of the jaw housing using a non-sharp rod.

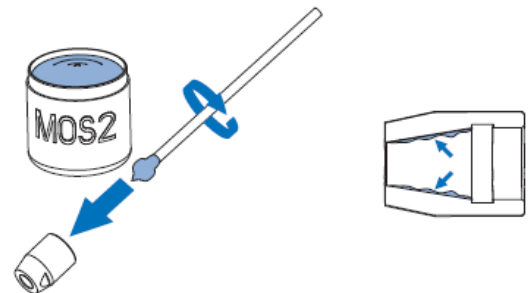

- 7 Reassemble the elements in reverse order of disassembly, tighten the jaw housing to 15 Nm.

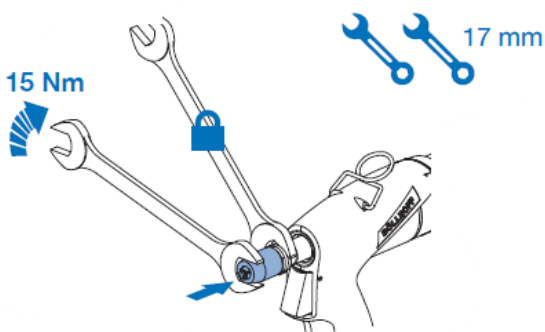

- 8 Reassemble and tighten the nose to 10 Nm.

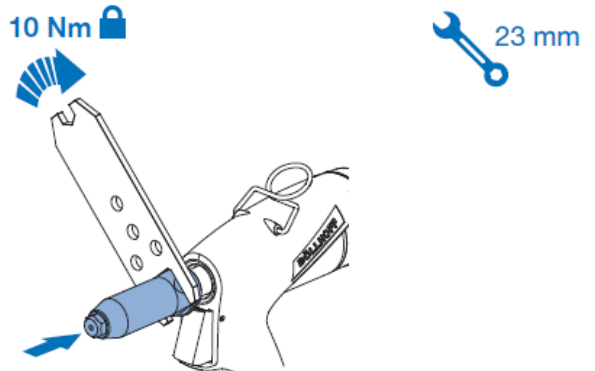

8.6 Jaws position adjustment

⚠ DANGER



Risk of crushing and cutting!

When riveting the RIVQUICK®, be very vigilant, an unexpected triggering of the riveting cycle could cause injuries.

! NOTE

Jaws position adjustment is very important to ensure good grip on the stem without loss of pulling stroke, as well as good release of the broken stem during the evacuation phase to the broken stem collection bottle.

- If dimension L3 < recommended value, the jaws will be too open and the stroke loss will be significant, resulting in multi-cycle riveting.
- If dimension L3 > recommended value, the jaws will be too closed/released causing difficulties in introducing the rivet stem and risks of evacuation problems.

Check this adjustment once a month, using the procedure described below.

L3₁

RIVQUICK® P1010 : 15,5 ± 0,5 mm

RIVQUICK® P2010 : 15,5 ± 0,5 mm

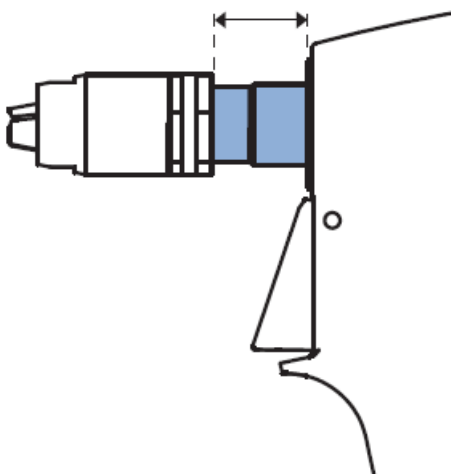

L4₂

RIVQUICK® P1010 : 33,5 ± 0,5 mm

RIVQUICK® P2010 : 33,5 ± 0,5 mm

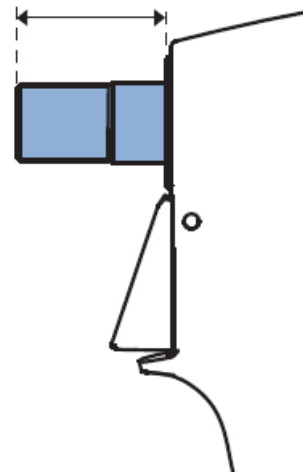

¹ We recommend using the adjustment fork MP52 reference **22603000422**.

² Whenever possible, we recommend checking dimension L4 which ensures the optimal position at the front stop of the hydraulic piston.

- 1 Using the special wrench provided, unscrew and remove the nose.

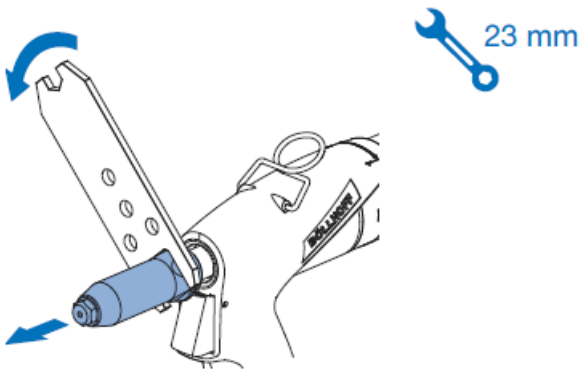

- 3 Continue to unscrew by hand the jaw housing and its lock nut sufficiently so that the adjustment fork can be installed.

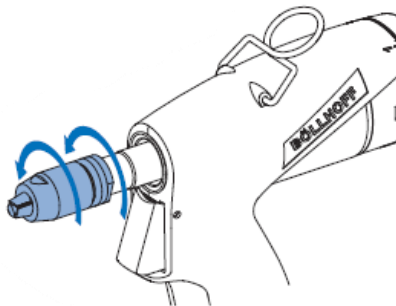

- 5 Install the adjustment fork on the hydraulic piston rod by placing one of its faces in contact with the hydraulic body.

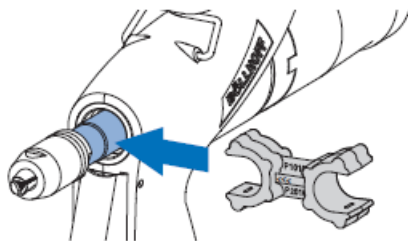

- 7 Remove the adjustment fork from the hydraulic piston.

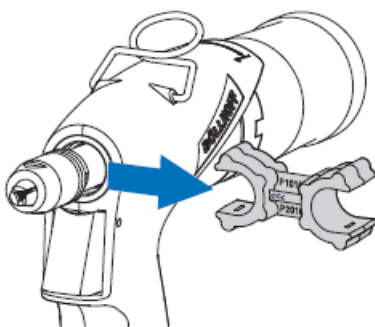

- 2 Using 2 flat and thin 17mm spanners, unscrew the jaws housing.

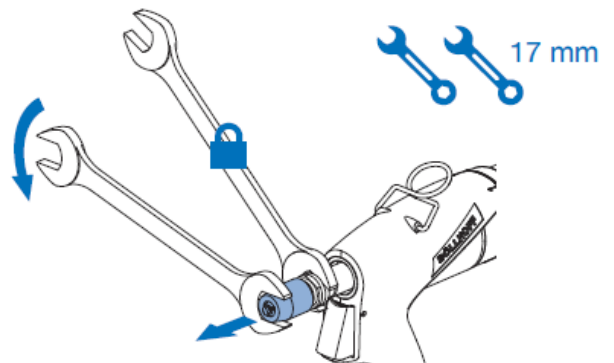

- 4 Choose the side of the fork that corresponds to your tool :
- 1 side is dedicated to RIVQUICK® P1010 & RIVQUICK® P2010
 - 1 side is dedicated to RIVQUICK® P3010
- The tool type and a directional arrow are engraved on the fork.



- 6 Screw by hand the lock nut (A) in contact with the fork and the jaw housing (B) in contact with the lock nut.

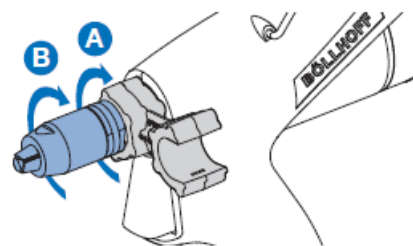

- 8 While maintaining the position of the lock nut with a 17 mm flat spanner, tighten the jaw housing to 10 Nm.

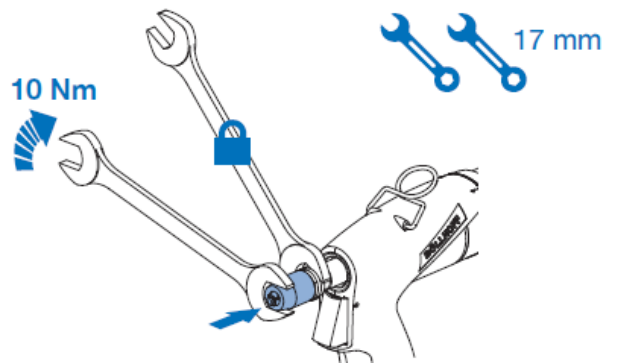

9. Split views and parts list

RIVQUICK® P1010

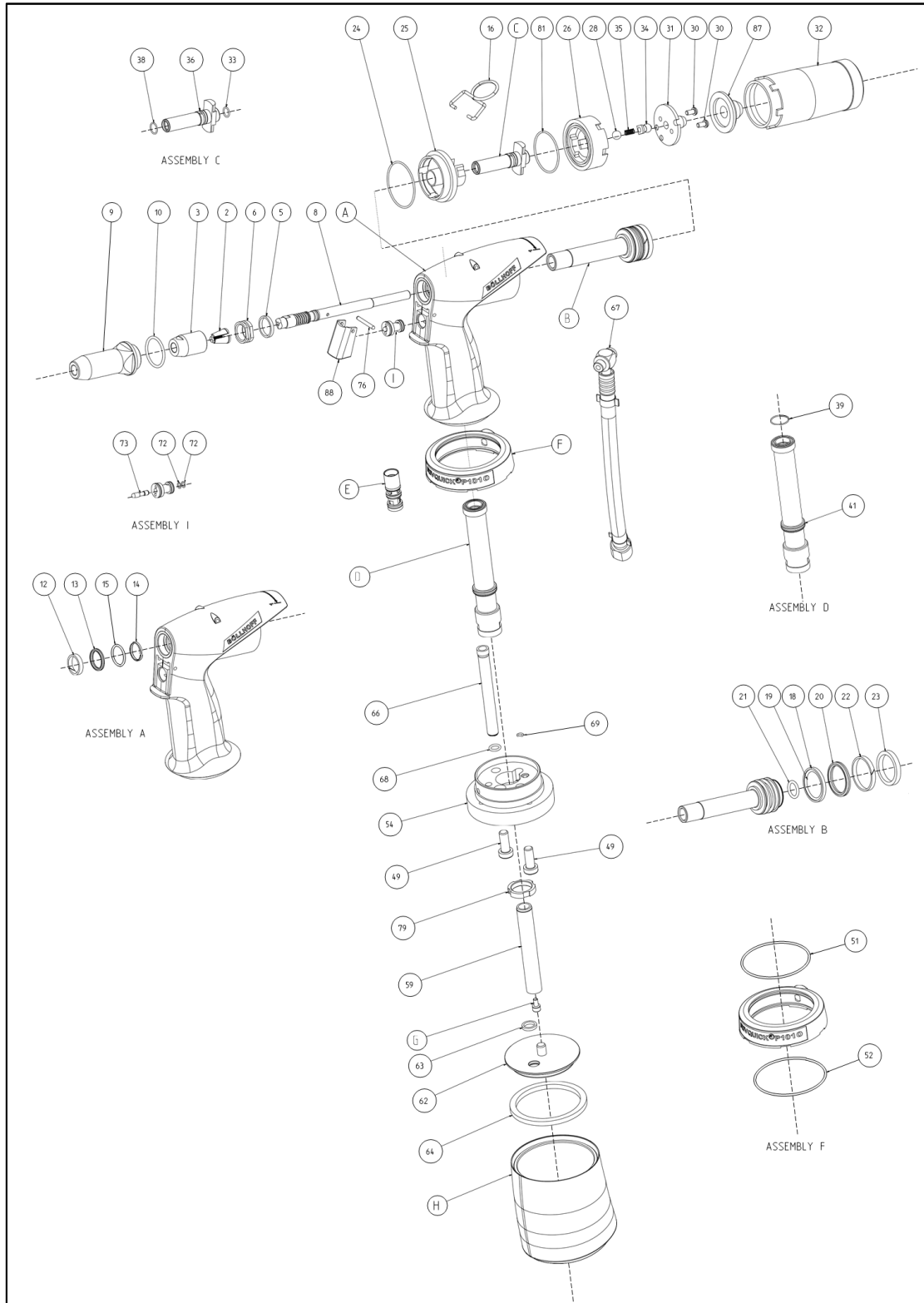

Repère	Description	Référence	Qté
2	Set of 3 jaws	22603000002	1
3	Clamping sleeve	22603000003	1
5	Scraper ring	22603000005	1
6	Nut HP M15,5x1	22603000006	1
8	Conduit suction	22603000008	1
9	Front nozzle	22603000009	1
10	O-ring 25/2.5 Sh70	22603000010	1
12	Guiding band	22603000012	1
13	X-ring 15.54x2.62 Sh70	22603000013	1
14	Stepseal Ø16	22603000014	1
15	O-ring 25/2.5 Sh90	22603000015	1
16	Hanger	22603000016	1
18	Stepseal Ø32	22603000018	1
19	O-ring 22/3 Sh70	22603000019	1
20	X-ring 24.99x3.53 Sh70	22603000020	1
21	O-ring 12/2.5 VITON	22603000021	1
22	Guiding band	22603000022	1
23	Seal Ø32	22603000023	1
24	O-ring 40.6/1.5 Sh70	22603000024	1
25	Nut of body	22603000025	1
26	Wheel	22603000026	1
28	Steel ball 8	22603000028	1
30	Screw M4x10 imbus DIN7380 zinc	22603000030	2
31	Hood	22603000031	1
32	Mandrel container	22603301002	1
33	O-ring 7.6/1.3 Sh70	22603000033	1
34	Small pin	22603000034	1
35	Spring	22603000035	1
36	O-ring 10/1.5 Sh70	22603000036	1
38	O-ring 9/1.3 Sh70	22603000038	1
39	O-ring 15/1.5 Sh90	22603000039	1
41	O-ring 18/2.2 VITON	22603000041	1
49	Screw M8x20 imbus DIN7984	22603000049	2
51	O-ring 60/2 Sh70	22603000051	1
52	O-ring 63/2 Sh70	22603000052	1
54	Body bottom	22603000054	1
59	Pneumatic piston	22603000059	1
62	Pneumatic piston board	22603000062	1
63	Lip seal 14	22603000063	1
64	Seal Ø70	22603000064	1
66	Tube complete	22603301003	1
67	Aircoupling	22603000067	1
68	O-ring 7/2 Sh70	22603000068	2
69	O-ring 4/1.5 Sh70	22603000069	1
72	O-ring 4/1 Sh70	22603000072	2
73	Trigger piston	22603000073	1
76	Trigger pin	22603000076	1
79	Nut of body	22603000079	1
81	O-ring 36/2 Sh70	22603000081	1
87	Protective sleeve	22603301004	1
88	Simple trigger	22603000088	1

Repère	Description	Référence	Qté
A	Hydraulic body complete	22603301001	1
B	Hydraulic piston complete	22603000271	1
C	Bush complete	22603000272	1
D	Insert PP complete	22603000273	1
E	Main cycle distributor kit	22603000202	1
F	Complete air supply assembly	22603000275	1
G	Piston seal screw kit	22603000276	1
H	Pneumatic cylinder group	22603000277	1
I	Trigger distributor	22603000203	1

Repère	Description	Référence	Qté
2	Set of 3 jaws	22603000002	1
3	Clamping sleeve	22603000003	1
5	Scraper ring	22603000005	1
6	Nut HP M15,5x1	22603000006	1
8	Conduit suction	22603100008	1
9	Front nozzle	22603000009	1
10	O-ring 25/2.5 Sh70	22603000010	1
12	Guiding band	22603000012	1
13	X-ring 15.54x2.62 Sh70	22603000013	1
14	Stepseal Ø16	22603000014	1
15	O-ring 25/2.5 Sh90	22603000015	1
16	Hanger	22603000016	1
18	Stepseal Ø32	22603000018	1
19	O-ring 22/3 Sh70	22603000019	1
20	X-ring 24.99x3.53 Sh70	22603000020	1
21	O-ring 12/2.5 VITON	22603000021	1
22	Guiding band	22603000022	1
23	Seal Ø32	22603000023	1
24	O-ring 40.6/1.5 Sh70	22603000024	1
25	Nut of body	22603000025	1
26	Wheel	22603000026	1
28	Steel ball 8	22603000028	1
30	Screw M4x10 imbus DIN7380 zinc	22603000030	2
31	Hood	22603000031	1
32	Mandrel container	22603301002	1
33	O-ring 7.6/1.3 Sh70	22603000033	1
34	Small pin	22603000034	1
35	Spring	22603000035	1
36	O-ring 10/1.5 Sh70	22603000036	1
38	O-ring 9/1.3 Sh70	22603000038	1
39	O-ring 15/1.5 Sh90	22603100039	1
41	O-ring 18/2.2 VITON	22603000041	1
49	Screw M8x20 imbus DIN7984	22603000049	2
51	O-ring 60/2 Sh70	22603000051	1
52	O-ring 63/2 Sh70	22603000052	1
54	Body bottom	22603000054	1
59	Pneumatic piston	22603000059	1
62	Pneumatic piston board	22603000062	1
63	Lip seal 14	22603000063	1
64	Seal Ø70	22603000064	1
66	Tube complete	22603401003	1
67	Aircoupling	22603100067	1
68	O-ring 7/2 Sh70	22603000068	2
69	O-ring 4/1.5 Sh70	22603000069	1
72	O-ring 4/1 Sh70	22603000072	2
73	Trigger piston	22603000073	1
76	Trigger pin	22603000076	1
79	Nut of body	22603000079	1
81	O-ring 36/2 Sh70	22603000081	1
87	Protective sleeve	22603301004	1

Repère	Description	Référence	Qté
88	Simple trigger	22603000088	1
A	Hydraulic body complete	22603401001	1
B	Hydraulic piston complete	22603000271	1
C	Bush complete	22603000272	1
D	Insert PP complete	22603100273	1
E	Main cycle distributor kit	22603000202	1
F	Complete air supply assembly	22603100275	1
G	Piston seal screw kit	22603000276	1
H	Pneumatic cylinder group	22603100277	1
I	Trigger distributor	22603000203	1

10. Packaging and transport

! NOTE

The tool is delivered in packaging suitable for transport. Keep this packaging for any subsequent transport.

⚠ ATTENTION

When transporting the tool, ensure that it is protected against shocks and vibrations. Use appropriate packaging.

Never handle the tool by holding it by the pneumatic hose.

Packaging dimensions and weight

- Length : 350 mm
- width : 250 mm
- height : 100 mm
- Gross weight : approximately 2.5kg P1010 / 3.0 kg P2010.

Packaging material

- Corrugated cardboard



All packaging materials are recyclable and must be disposed of in accordance with local regulations in force.

Storage conditions

- Temperature : -20°C to +70°C
- Relative humidity: 5% to 80% without condensation.
- Store in a dry, clean place away from direct sunlight.

With or without its packaging, the appliance must not be subjected to aggressive or corrosive atmospheres.

The tool, without its packaging, must be used in the following conditions:

- Temperature from 0 to +40°C
- Relative humidity from 5% to 80%.

11. End-of-life management

! NOTE

Environmental protection is a priority for Böllhoff. We are committed to minimizing the environmental impact of our products throughout their life cycle.

Decommissioning of the tool

When the tool reaches the end of its life and can no longer be repaired or refurbished, it must be decommissioned appropriately.

⚠ ATTENTION

Before scrapping the tool, completely drain the hydraulic oil. Used oil must be collected and disposed of in accordance with local regulations in force.

Disassembly and sorting of components

The RIVQUICK® tool is composed of different materials that must be sorted for optimal recycling:

Ferrous metals (steel, cast iron) :

- Tool body
- Hydraulic tank
- Piston
- Jaws
- Nose

Non-ferrous metals (aluminium) :

- Some internal components

Elastomers and seals :

- O-rings
- Seals

Plastics :

- Collection bowl
- Handle
- Rubberized protection

Fluids :

- Hydraulic oil (to be completely drained)

Recycling and disposal



The different materials must be disposed of in accordance with local and national regulations in force:

- Ferrous and non-ferrous metals can be recycled in specialized recycling centers.
- Elastomers and seals must be disposed of in accordance with industrial waste regulations.
- Plastics can be recycled if properly sorted.
- Used hydraulic oil must be collected and treated by approved companies.

! NOTE



Never dispose of the tool with household waste. Contact your local Böllhoff representative or an approved recycling center for information on proper tool disposal.

WEEE Directive (Waste Electrical and Electronic Equipment)

Although this tool is primarily mechanical and hydraulic, some electronic components may be present in specific versions. These components must be treated in accordance with the WEEE directive.

Böllhoff commitment to the environment

Böllhoff is committed to designing sustainable products and promoting the circular economy. We encourage the repair and refurbishment of our tools to extend their lifespan.

For any questions regarding the end-of-life management of your **RIVQUICK®** tool, please contact your local Böllhoff representative.

BOLLHOFF

Passion for successful joining.

Böllhoff Group

Innovative partner in the field of fastening technology, assembly solutions and logistics. You will find the contact details of our sites worldwide at www.bollhoff.com.

Rue Archimède | Z.I. de l'Albanne | CS 40068 | F-73493 La Ravoire Cedex
Tél : +33 4 79 96 70 00 | Fax : +33 4 79 96 70 11
info_fr@bollhoff.com | www.bollhoff.fr

CONFIDENTIAL – This document and all associated information are the property of BOLLHOFF OTALU SAS, subject to third party rights. Its communication is not a transfer of ownership. Its communication is only for the purposes of internal use and may only be communicated to persons with a need to know. Any other use is strictly prohibited without the consent of BOLLHOFF OTALU SAS.